

MAPA CHAVE ARTICULAÇÃO URBANA
ORTOGRAFIA 1:1000
SEM ESCALA

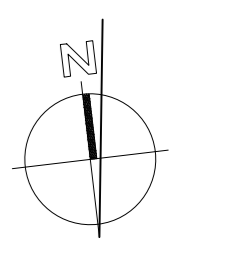

MAPA GEOGRÁFICO
1:40000

SECRETARIA DE ESTADO DE OBRAS E INFRAESTRUTURA - SOOF		R. ANDRÉ BRAGAÇA CALLE AZEVEDO	
PROJETO DE GEOMETRIA			
INF GEM-1C 005/2018		PLANO PILOTO - RA PP OBRA DE COMPLEMENTAÇÃO DO CORREDOR EXCLUSIVO DE ÔNIBUS NA ESPIRA COM O ACESSO AO TERMINAL ASA SUL - TAS PROJETO DE GEOMETRIA	
GERAL	FOLHA: 01/04	ESCALA: 1:1000	DATA: OUTUBRO/2023
PROJETO: UNIBUS	REVISÃO: ANULISTA	VISTO: CHEFE DE UNIDADE	APROVO: SUBSECRETARIA SUPOP

PERFIL ALINHAMENTO – EIXO 54

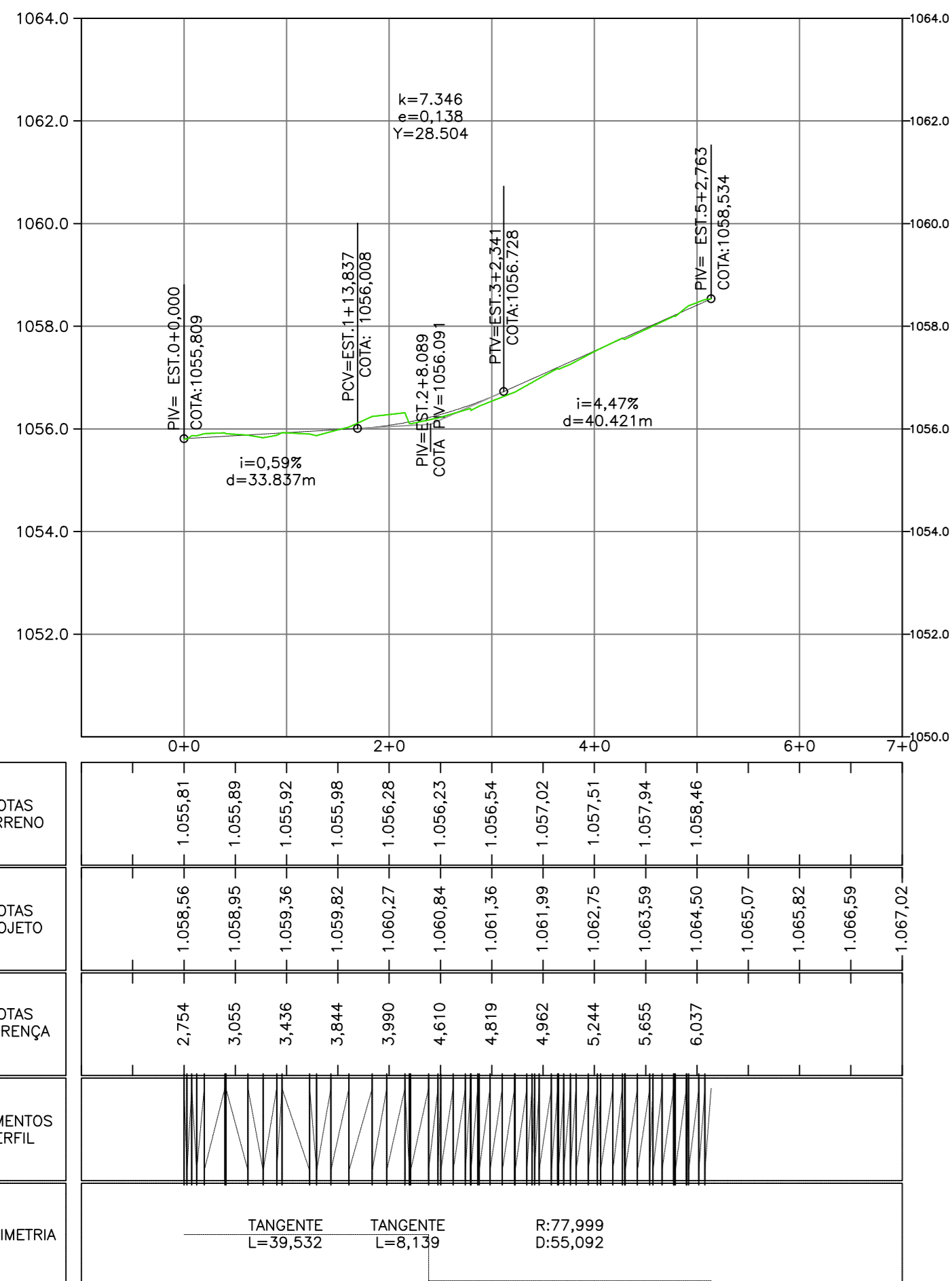

PERFIL ALINHAMENTO – EIXO 56

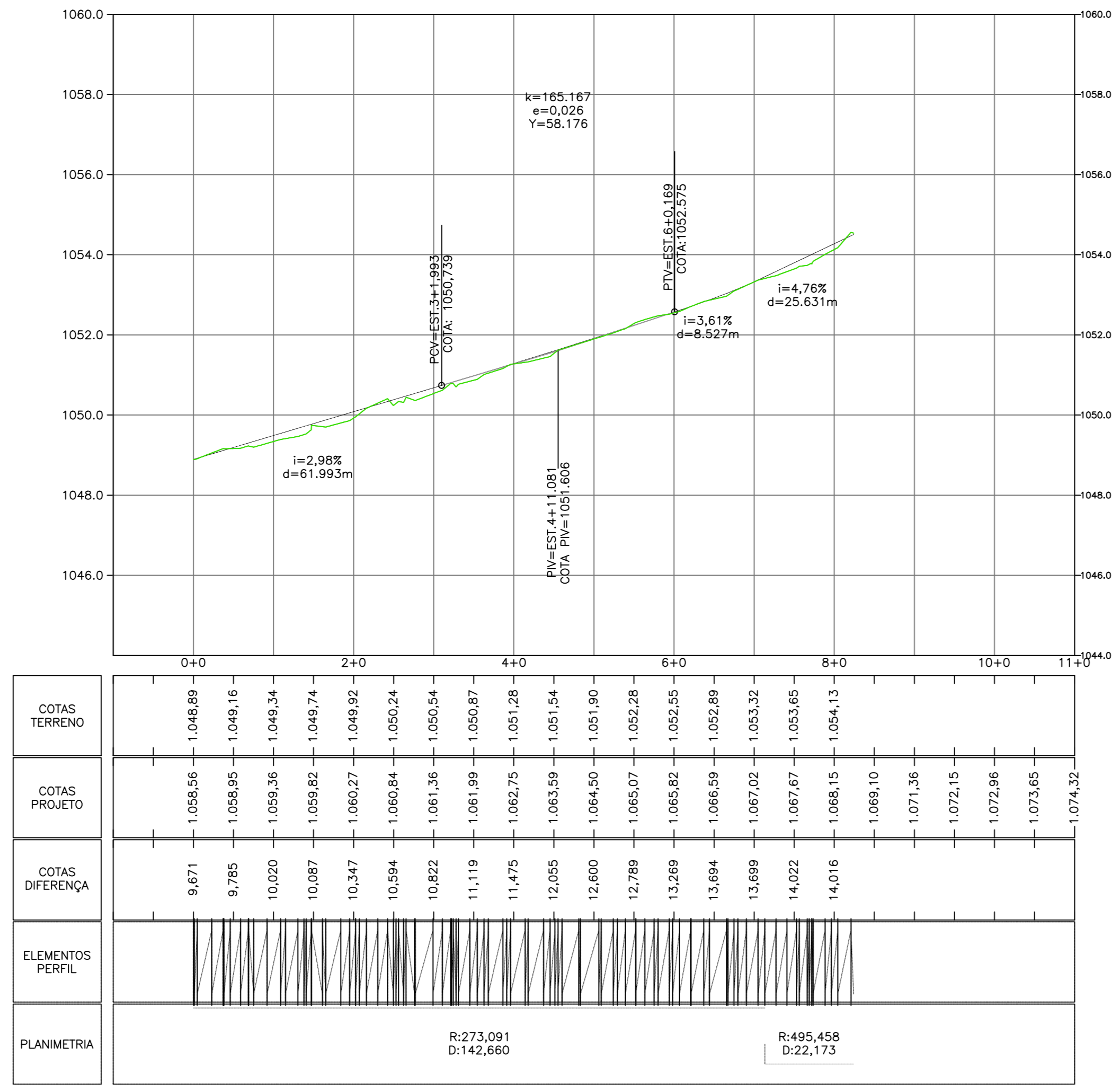

PERFIL ALINHAMENTO – EIXO 57

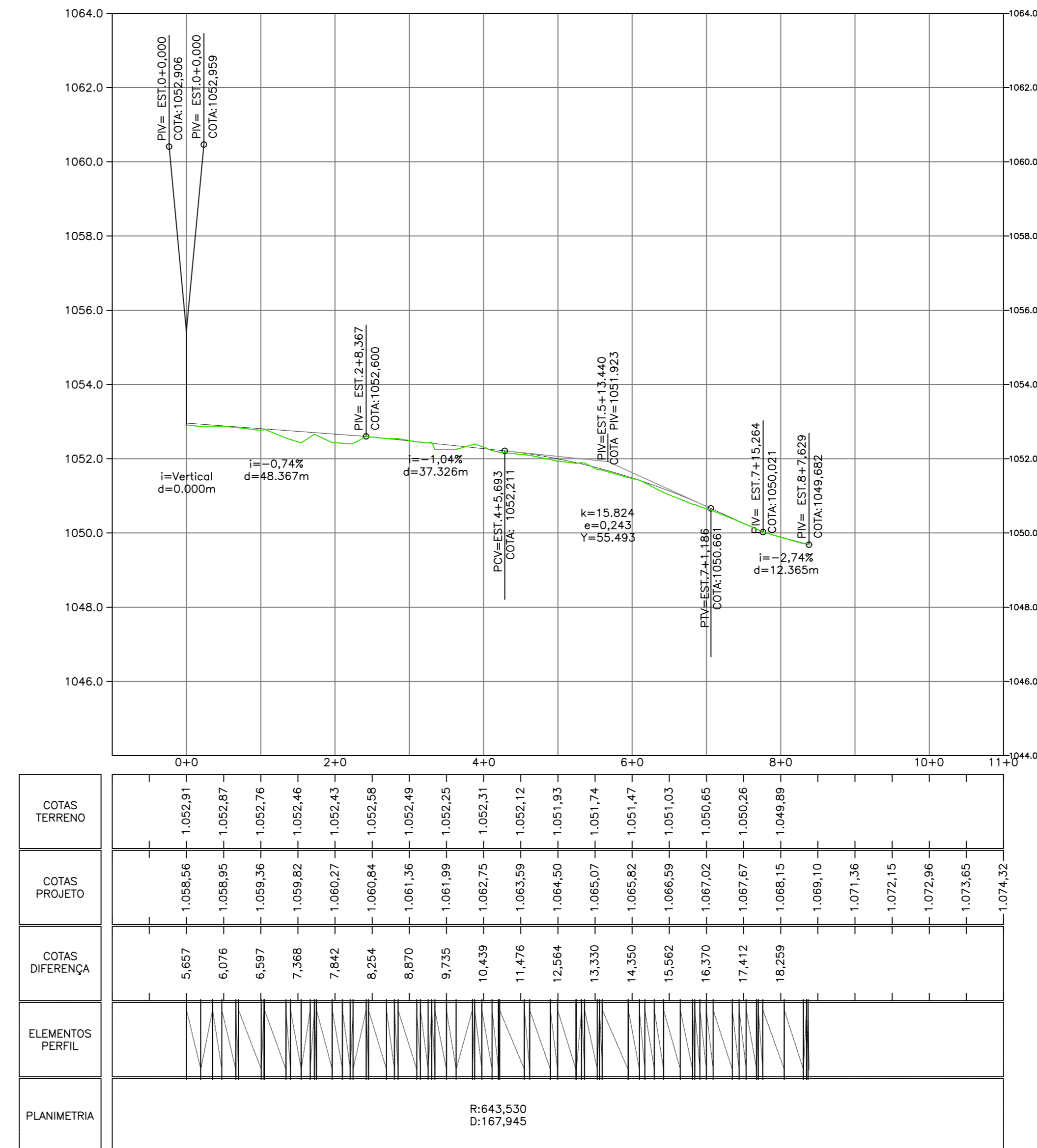

PERFIL ALINHAMENTO – EIXO 59

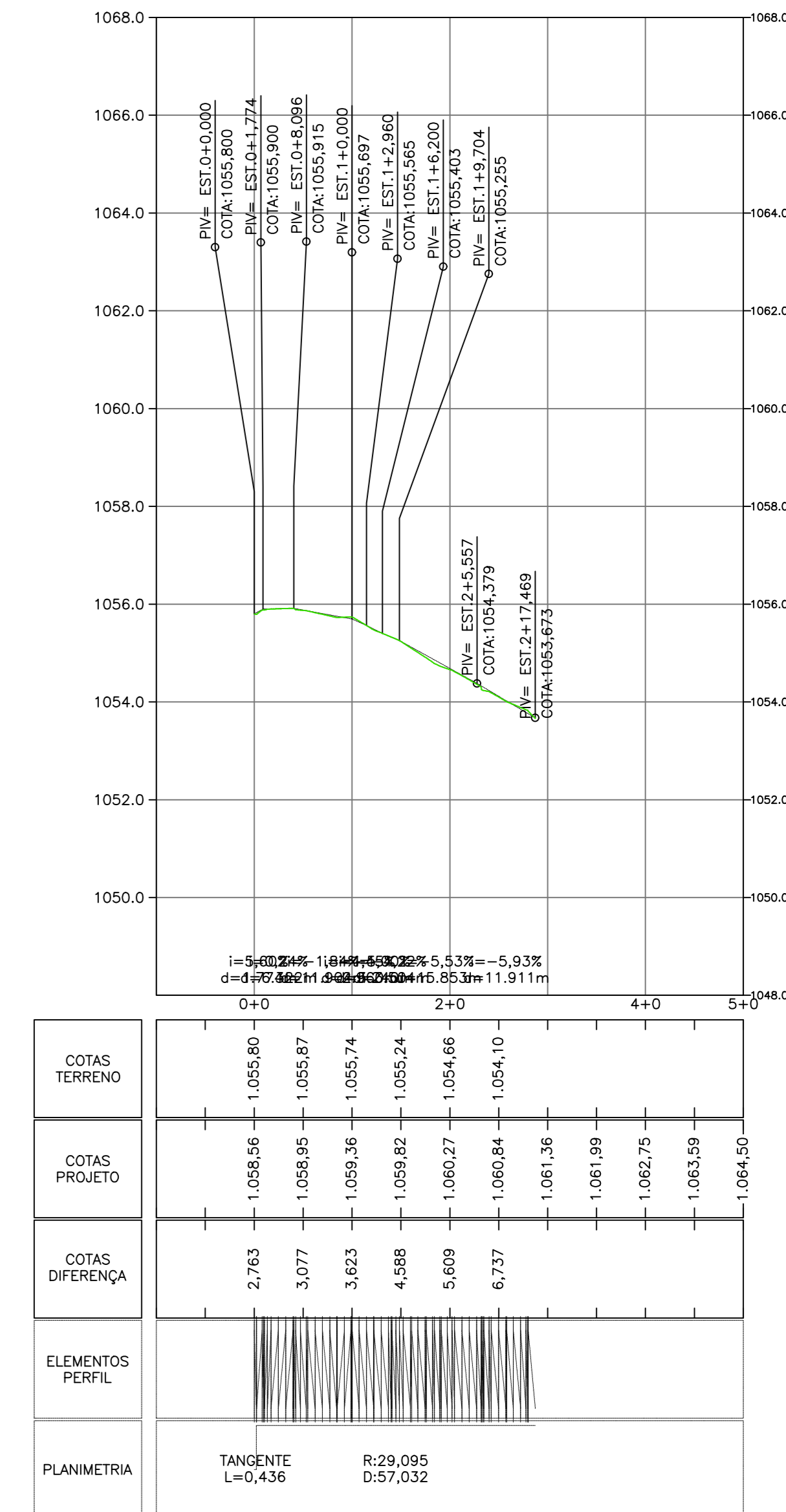

PERFIL ALINHAMENTO – EIXO 60

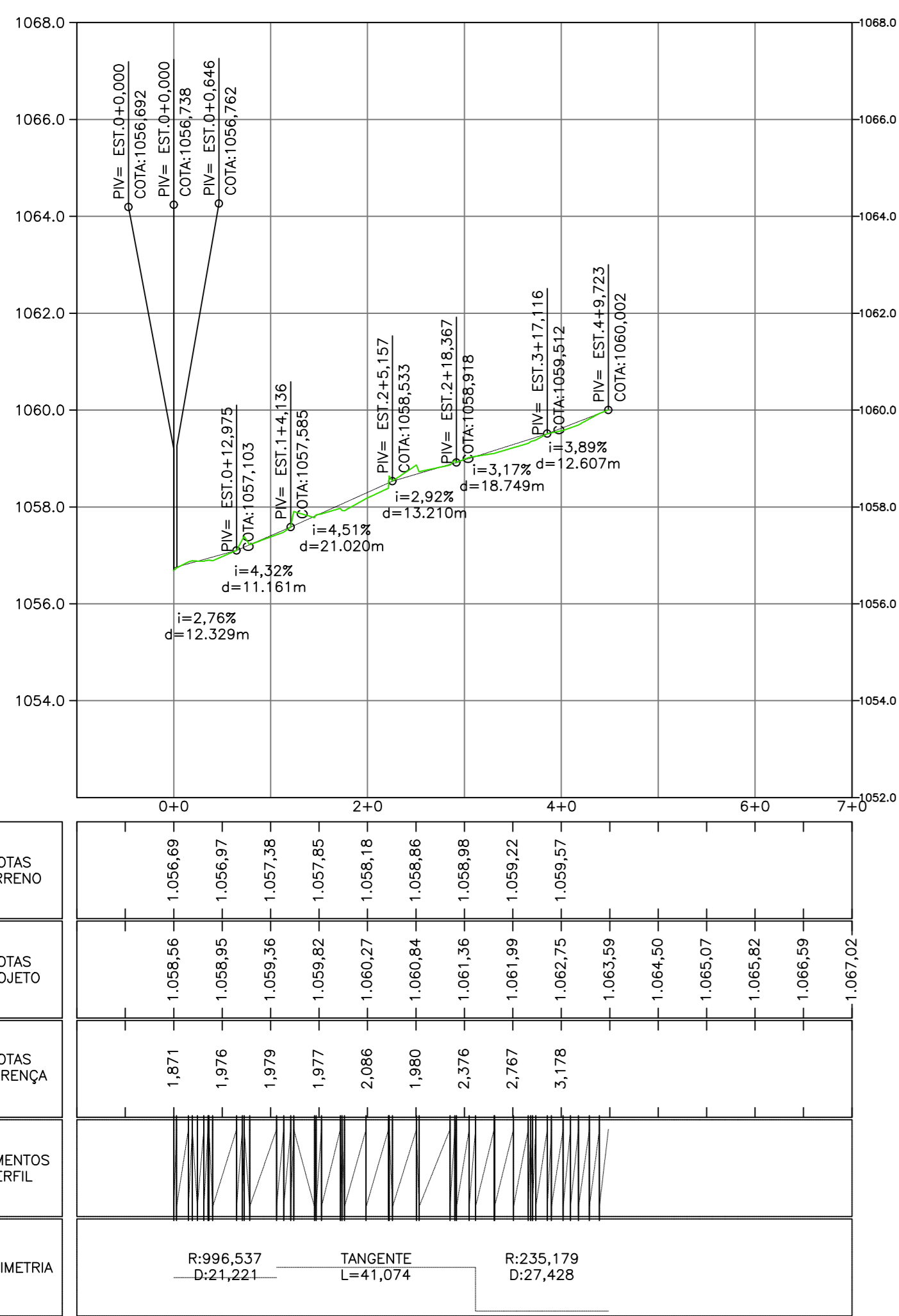

PERFIL ALINHAMENTO – EIXO 61

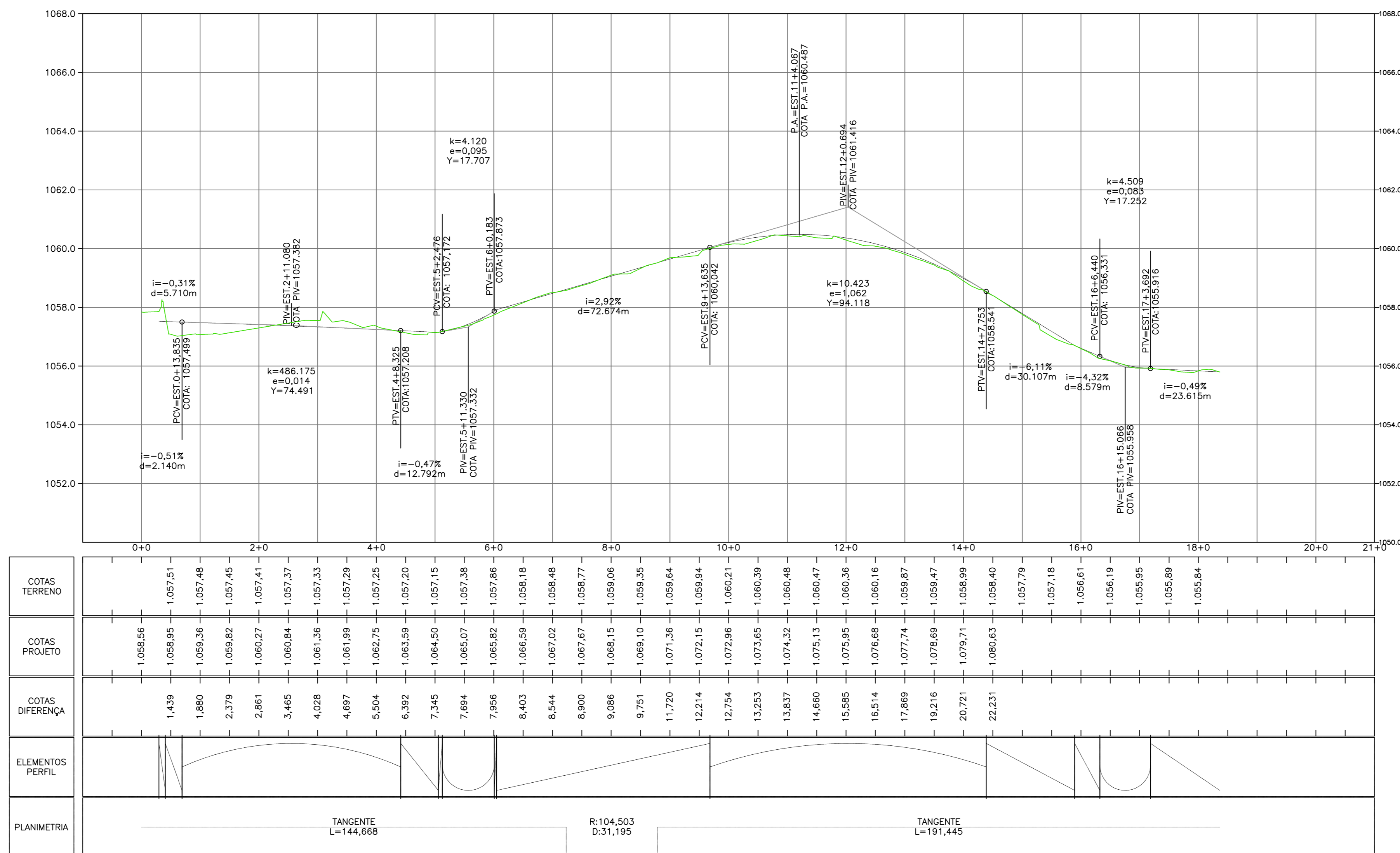

PERFIL ALINHAMENTO – EIXO 64

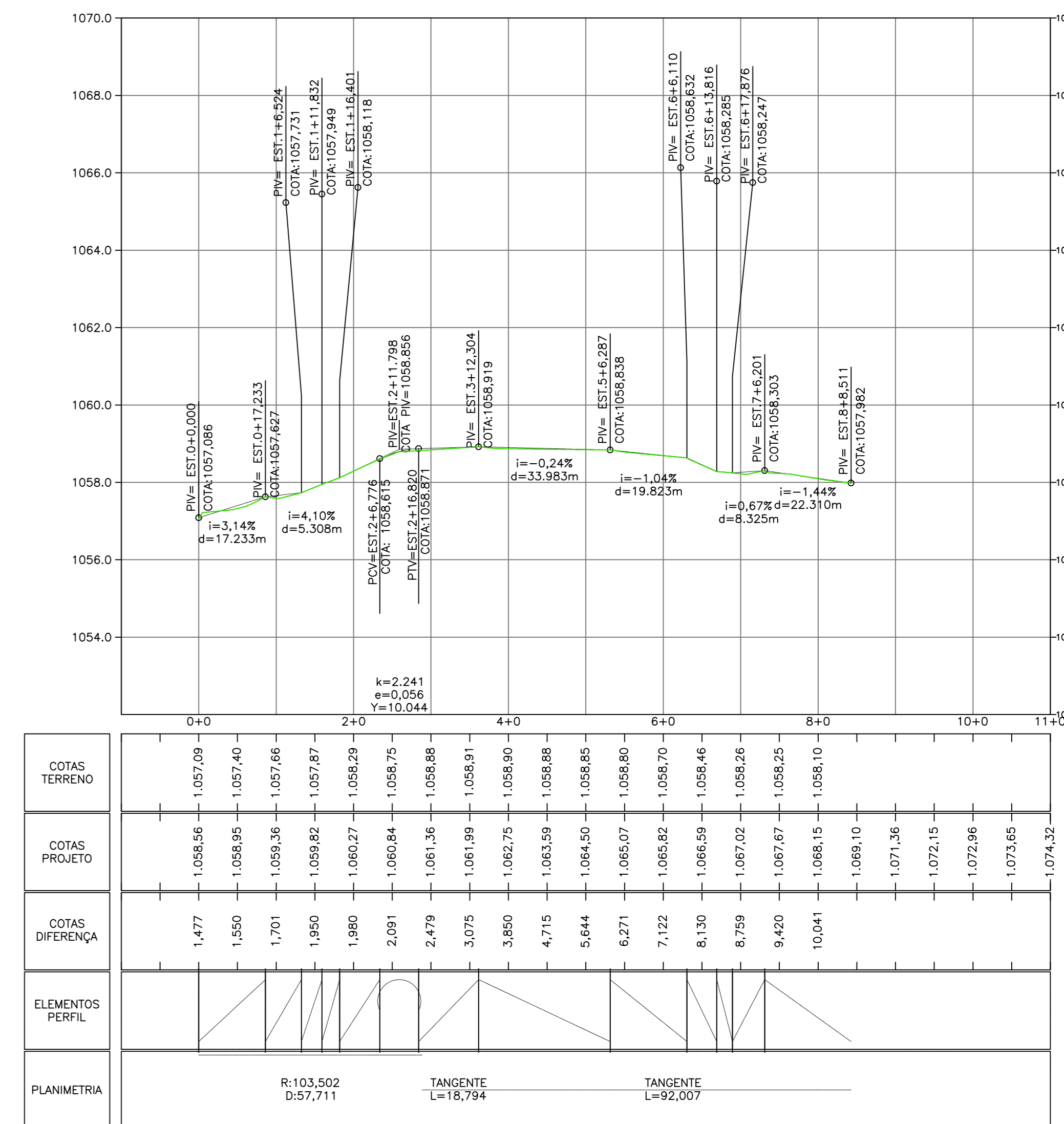

PERFIL ALINHAMENTO – EIXO 53

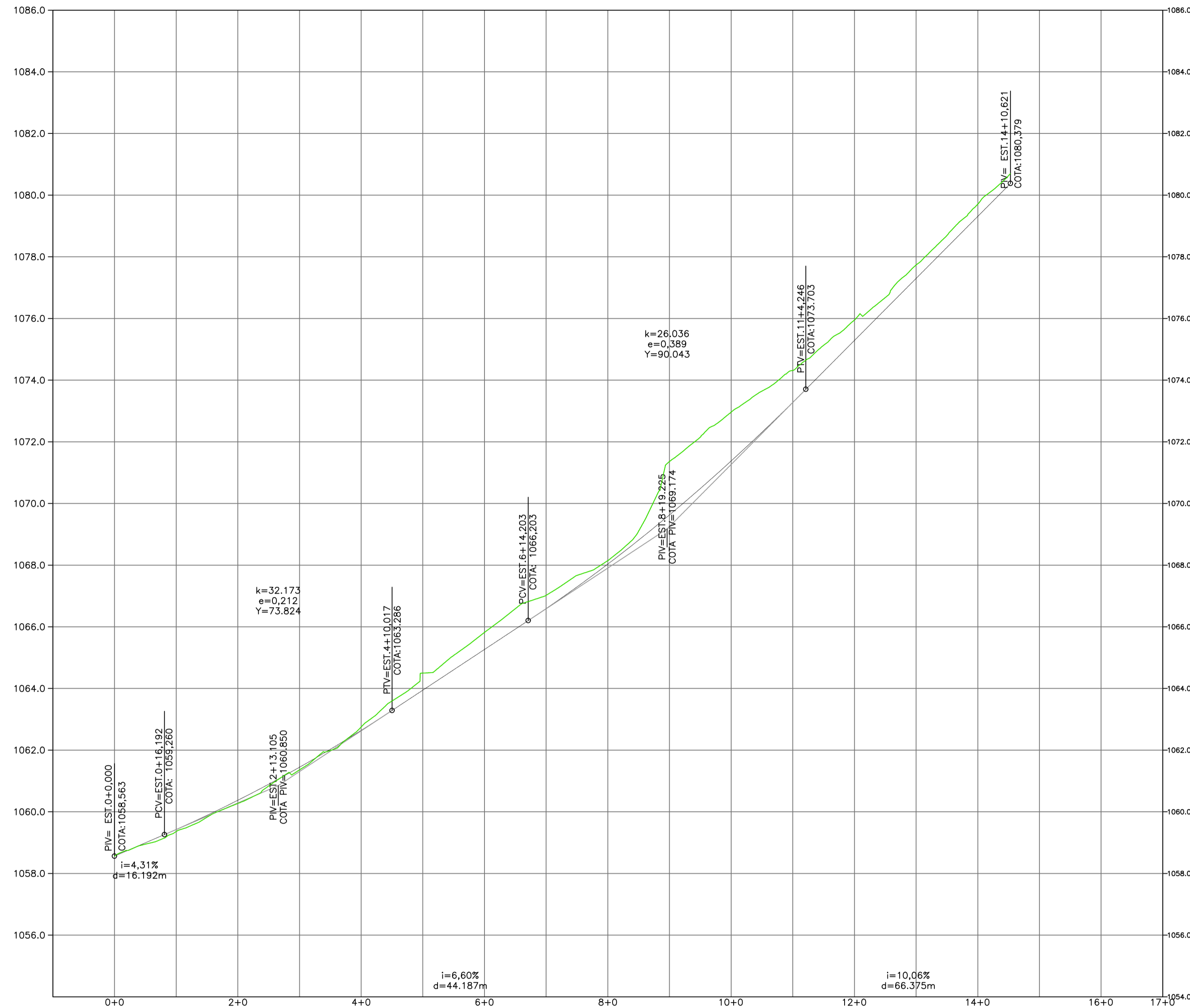

COTAS TERRENO	COTAS PROJETO	COTAS DIFERENÇA	ELEMENTOS PERFIL	PLANIMETRIA
1.058,56	1.058,56	0,000	[Profile Element]	R:78,999 D:75,384
1.058,99	1.058,99	0,044		
1.059,43	1.059,43	0,067	[Profile Element]	R:765,501 D:74,799
1.059,88	1.059,88	0,060		
1.060,37	1.060,37	0,103	[Profile Element]	TANGENTE L=98,566
1.060,89	1.060,89	0,056		
1.061,44	1.061,44	0,085	[Profile Element]	TANGENTE L=41,872
1.062,03	1.062,03	0,040		
1.062,64	1.062,64	-0,110	[Profile Element]	
1.063,29	1.063,29	-0,307		
1.063,95	1.063,95	-0,553	[Profile Element]	
1.064,61	1.064,61	-0,466		
1.065,27	1.065,27	-0,563	[Profile Element]	
1.065,93	1.065,93	-0,662		
1.066,59	1.066,59	-0,429	[Profile Element]	
1.067,29	1.067,29	-0,375		
1.068,10	1.068,10	-0,113	[Profile Element]	
1.068,81	1.068,81	-0,292		
1.069,63	1.069,63	-1,736	[Profile Element]	
1.070,48	1.070,48	-1,666		
1.072,96	1.072,96	-1,586	[Profile Element]	
1.073,65	1.073,65	-1,336		
1.074,32	1.074,32	-1,037	[Profile Element]	
1.075,13	1.075,13	-0,848		
1.075,95	1.075,95	-0,662	[Profile Element]	
1.076,68	1.076,68	-0,385		
1.077,74	1.077,74	-0,437	[Profile Element]	
1.078,31	1.078,31	-0,385		
1.078,69	1.078,69	-0,396	[Profile Element]	
1.079,71	1.079,71	-0,318		
1.080,63	1.080,63		[Profile Element]	

PERFIL ALINHAMENTO – EIXO 55

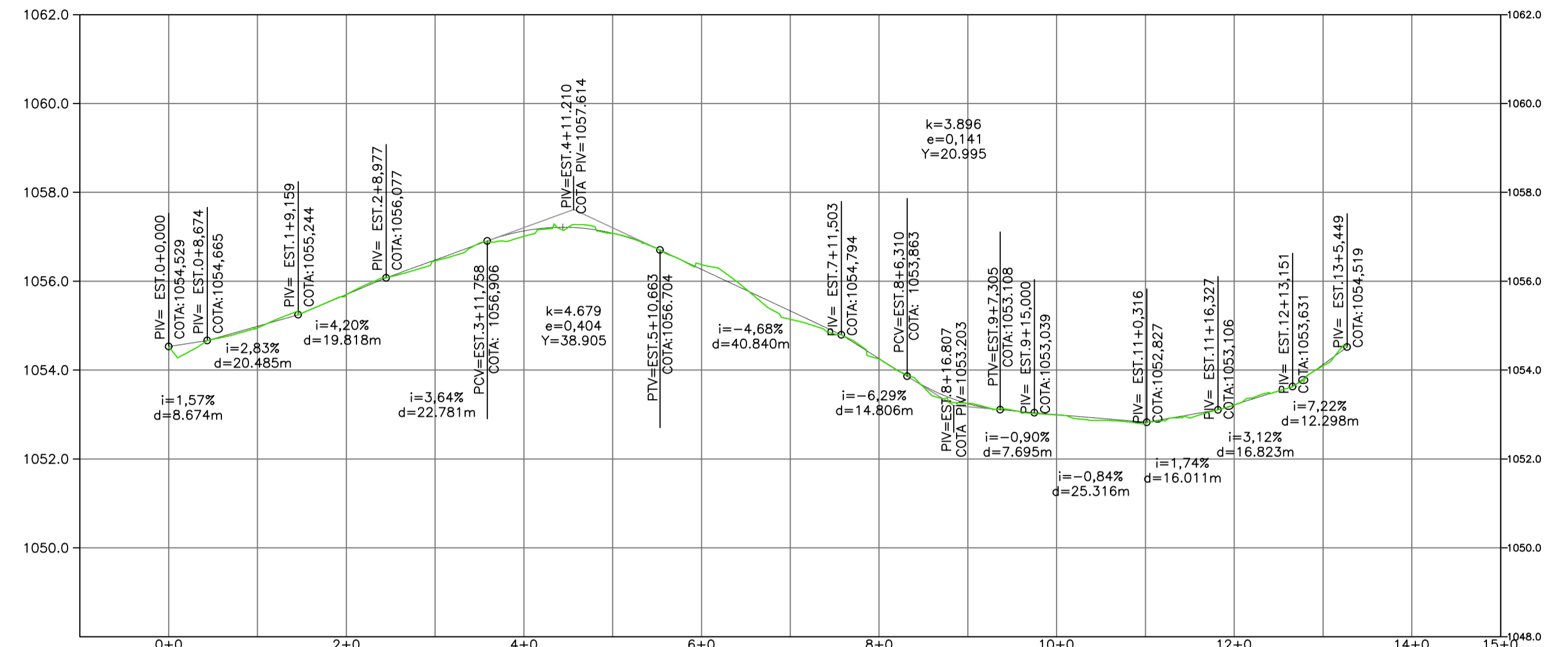

COTAS TERRENO	COTAS PROJETO	COTAS DIFERENÇA	ELEMENTOS PERFIL	PLANIMETRIA
1.054,33	1.058,56	4,034	[Profile Element]	R:497,007 D:67,156
1.054,68	1.058,95	4,257		
1.054,95	1.059,36	4,410	[Profile Element]	R:23,000 D:64,522
1.055,28	1.059,82	4,544		
1.055,69	1.060,27	4,581	[Profile Element]	R:53,000 D:17,101
1.056,10	1.060,84	4,737		
1.056,46	1.061,36	4,904	[Profile Element]	R:643,529 D:20,770
1.056,86	1.061,99	5,130		
1.057,01	1.062,75	5,740	[Profile Element]	R:553,090 D:34,968
1.057,21	1.063,59	6,378		
1.057,08	1.064,50	7,422	[Profile Element]	R:21,000 D:34,546
1.056,73	1.065,07	8,339		
1.056,38	1.065,82	9,443	[Profile Element]	R:23,000R:20,000 D:4,708 D:21,595
1.055,83	1.066,59	10,762		
1.055,14	1.067,02	11,878	[Profile Element]	
1.054,81	1.067,67	12,857		
1.054,25	1.068,15	13,897	[Profile Element]	
1.053,62	1.069,10	15,487		
1.053,25	1.071,36	18,111	[Profile Element]	
1.053,10	1.072,15	19,052		
1.052,98	1.072,96	19,972	[Profile Element]	
1.052,87	1.073,65	20,777		
1.052,78	1.074,32	21,532	[Profile Element]	
1.052,92	1.075,13	22,208		
1.053,22	1.075,95	22,734	[Profile Element]	
1.053,53	1.076,68	23,148		
1.054,09	1.077,74	23,643	[Profile Element]	
1.078,69	1.078,69			
1.079,71	1.079,71		[Profile Element]	
1.080,63	1.080,63		[Profile Element]	

EIXO 53

ESTACAS
0+0.00 ATÉ 1+5.00

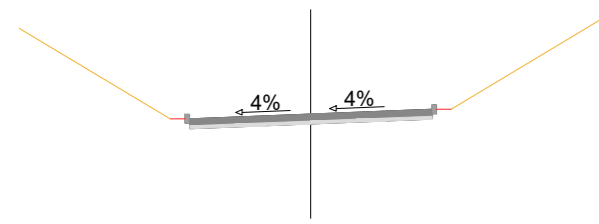

ESTACAS
3+10.00 ATÉ 14+10.00

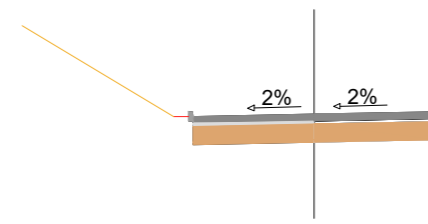

ESTACAS
1+5.00 ATÉ 3+10.00

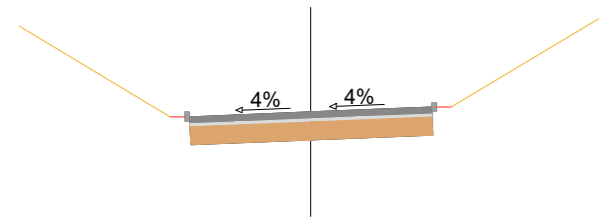

EIXO 54

ESTACAS
0+0.00 ATÉ 2+10.00

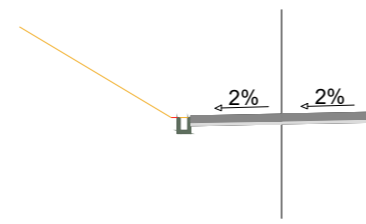

ESTACAS
2+10.00 ATÉ 5+2.76

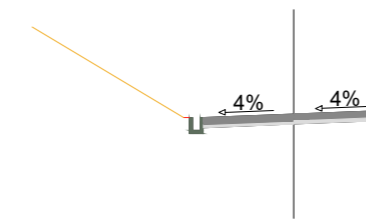

EIXO 55

ESTACAS
0+0.00 ATÉ 3+4.160

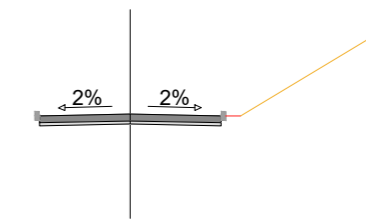

ESTACAS
7+7.78 ATÉ 10+5.00

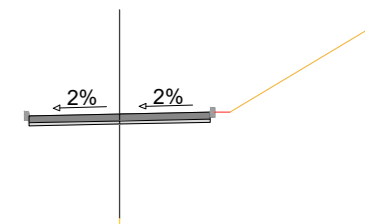

ESTACAS
3+4.160 ATÉ 7+7.78

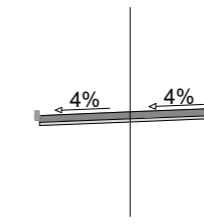

ESTACAS
10+5.00 ATÉ 13+5.00

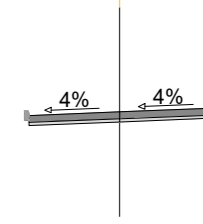

EIXO 56

ESTACAS
0+0.00 ATÉ 1+15.00

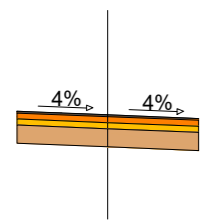

ESTACAS
2+19.065 ATÉ 8+0.00

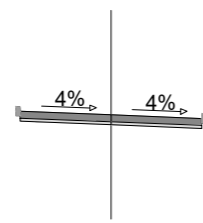

ESTACAS
1+15.00 ATÉ 2+19.065

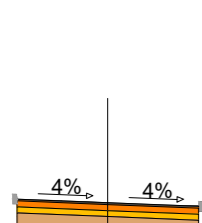

EIXO 57

ESTACAS
0+0.00 ATÉ 5+3.04

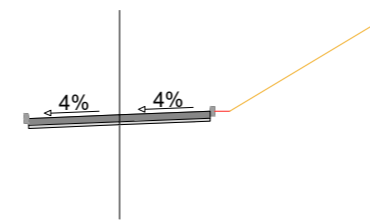

ESTACAS
6+10.00 ATÉ 8+5.00

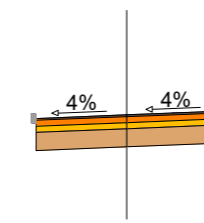

ESTACAS
5+3.04 ATÉ 6+10.00

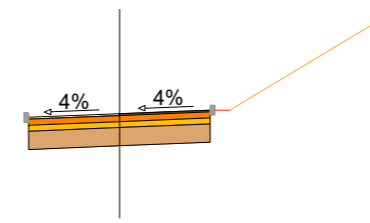

EIXO 59

ESTACAS
0+0.00 ATÉ 2+15.00

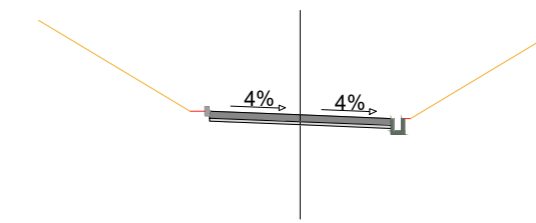

EIXO 60

ESTACAS
0+0.00 ATÉ 3+0.00

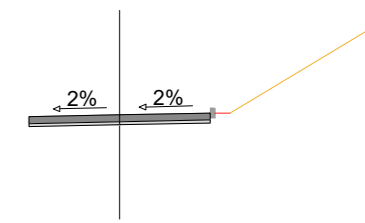

EIXO 61

ESTACAS
0+10.00 ATÉ 4+10.00

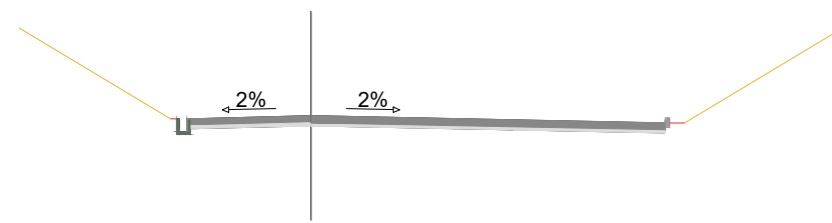

ESTACAS
6+0.00 ATÉ 7+0.00

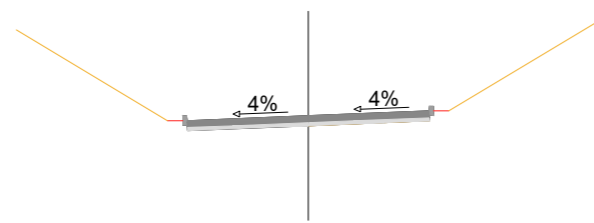

ESTACAS
5+0.00 ATÉ 5+10.00

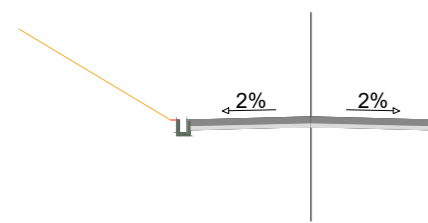

ESTACAS
9+0.00 ATÉ 18+0.00

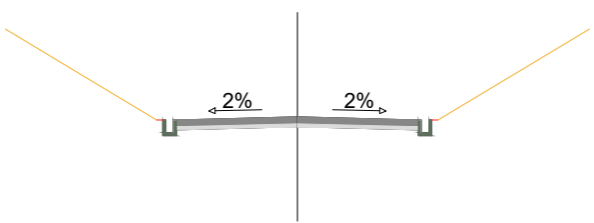

EIXO 64

ESTACAS
0+5.00 ATÉ 1+0.00

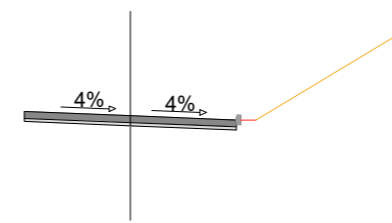

ESTACAS
2+17.72 ATÉ 8+8.51

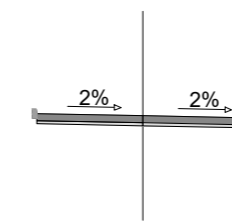

ESTACAS
1+0.00 ATÉ 2+17.72

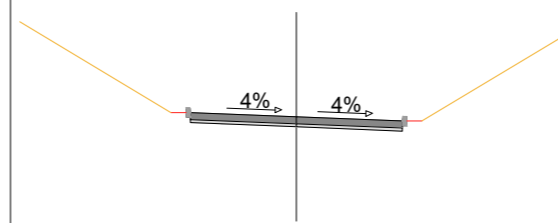

LEGENDA:

- PAVIMENTO DE CONCRETO 23 cm
- CCR - 10 cm
- PAVIMENTO FLEXIVEL - 6 cm
- CAMADA DE BASE - 20 cm
- CAMADA DE SUB BASE - 20 cm
- CAMADA SUB LEITO - 60 cm

SECRETARIA DE ESTADO DE OBRAS E INFRAESTRUTURA - SODF		RT: ANDRÉ BRAGANÇA CAU: A22970-9DF	
PROJETO DE GEOMETRIA			
INF GEM-1C 005/2018		PLANO PILOTO - RA PP OBRA DE COMPLEMENTAÇÃO DO CORREDOR EXCLUSIVO DE ÔNIBUS NA ESPM, COM O ACESSO AO TERMINAL ASA SUL - TAS PROJETO DE GEOMETRIA	
GERAL	FOLHA: 04/04	ESCALA: 1/250	DATA: OUTUBRO/2023
PROJETO: UNIMOB	REVISÃO: ANALISTA	VISTO: CHEFE DE UNIDADE	APROVO: SUBSECRETÁRIA SUPOP